

◆ Contents

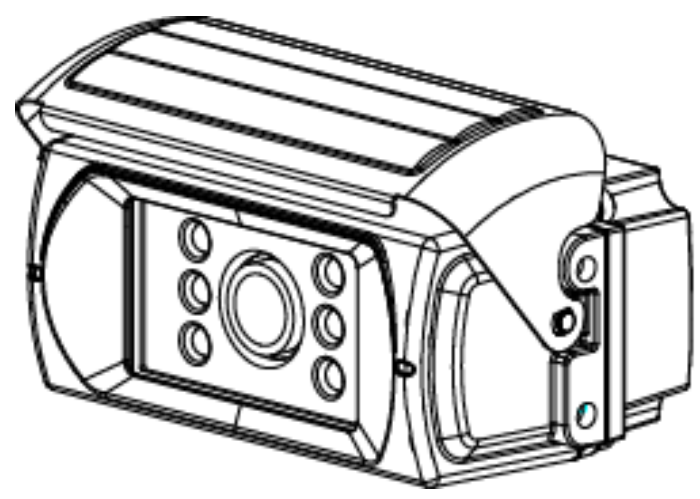

Camera x 1

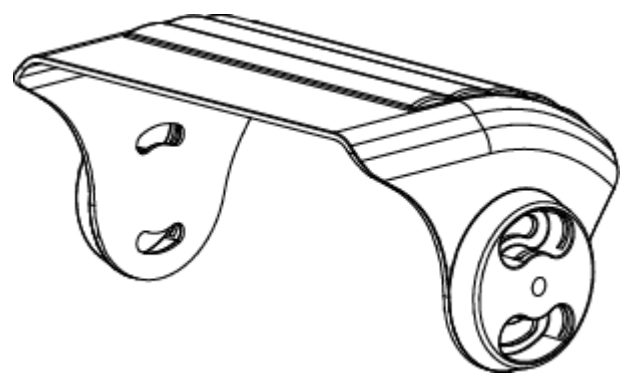

Sunshield x 1

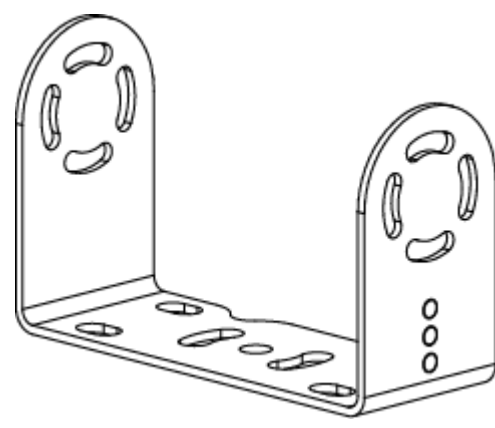

Bracket x 1

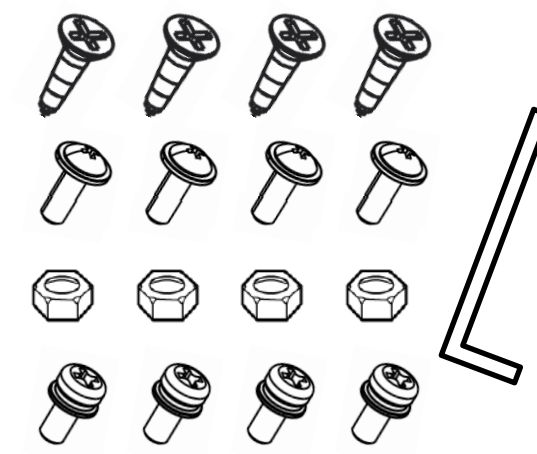

Camera Screw Kit x 1

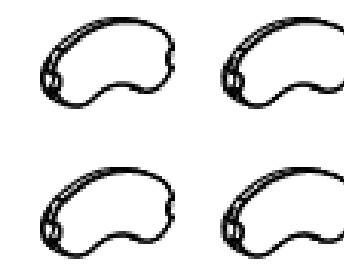

Screw cap cover x 4

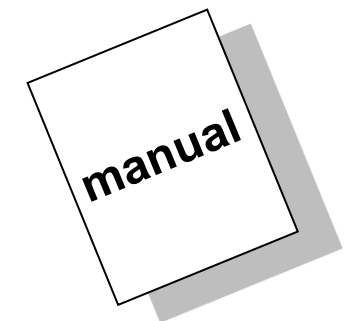

Instruction manual x 1

◆ Features

- Best picture quality (in combination with Digital LCD monitor)
- High resolution CCD camera (410.000 pixels)
- 1/3" Color CCD high resolution image sensor
- IP69K Waterproof Rating
- Diagonal 130° Viewing
- Normal/Mirror Image switching
- Ultra low light performance
- Automatic Electronic Iris
- Built-in Microphone
- Built-in IR LED's
- Built-in Automatic Heater (below +10°C)
- Temp. -40°C ~ 80°C
- Vibration resistant
- Auto shutter heating camera
- Motorized shutter (to protect the lens surface)
- Waterproof screw type connector (IP67), 4-pin mini-DIN
- E-mark.

◆ Technical Specifications

Image Sensor	1/3" Color SONY SUPER HAD II CCD
Scanning System	NTSC 410.000 pixels
Resolution	500 TV Lines
S/N ratio	Minimum 44dB (at AGC off)
Minimum Illumination	0 lux (IR LED's on)
Power supply	DC 9 ~ 48V
Power Consumption	DC 12V, 475mA (Heater on) DC 12V, 245mA (Heater off)
Operating Temperature	-40°C to +80°C
Field of View angle	130° (Diagonal), 102.2° (Horizontal), 72.8° (Vertical)
Dimension	102(W) x 43(H) x 63(D) mm
Weight	386g (total weight incl. bracket & sunvisor: 524g)

▪ Front View

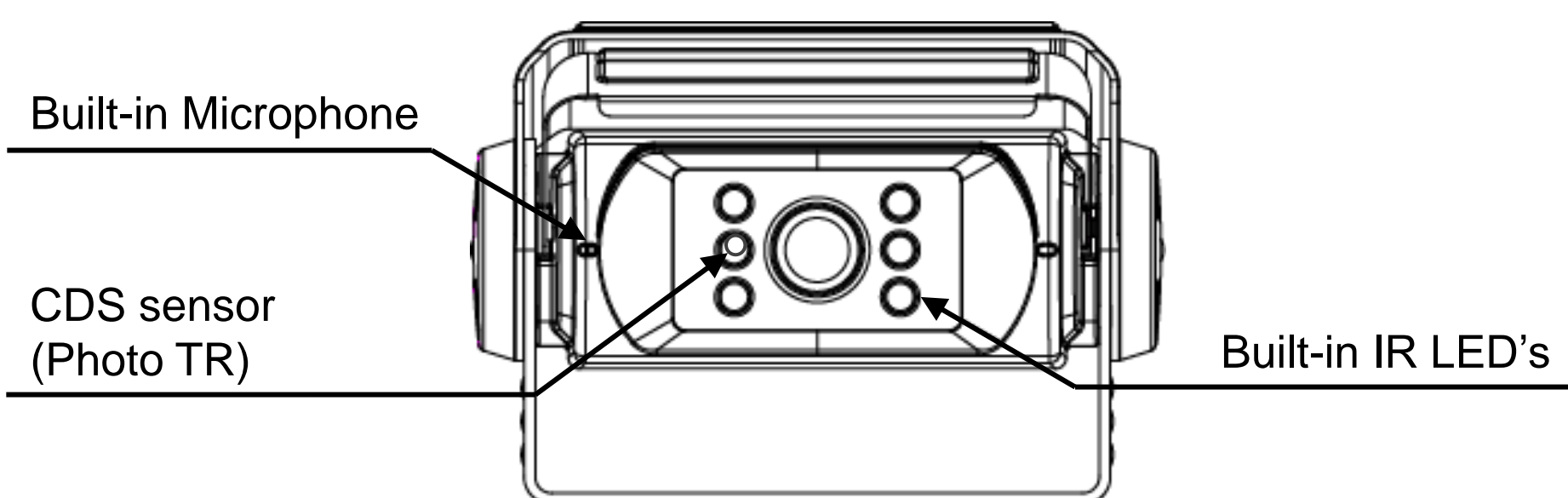

▪ Rear View

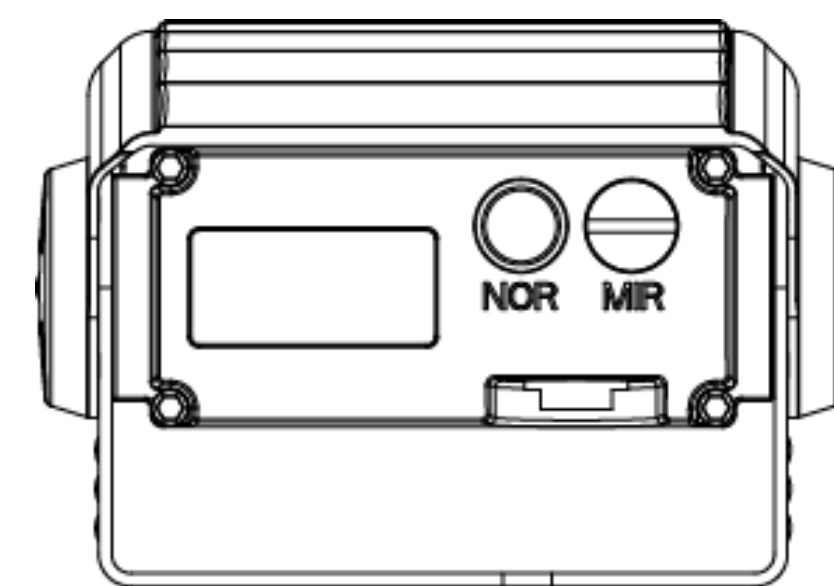

◆ Installation

▪ Camera Assembly

1. Fix the supplied mounting bracket to the vehicle.
2. Fix the bracket with camera and sun-shield according to drawing.
3. Adjust the viewing angle of the camera and fasten the screws firmly.

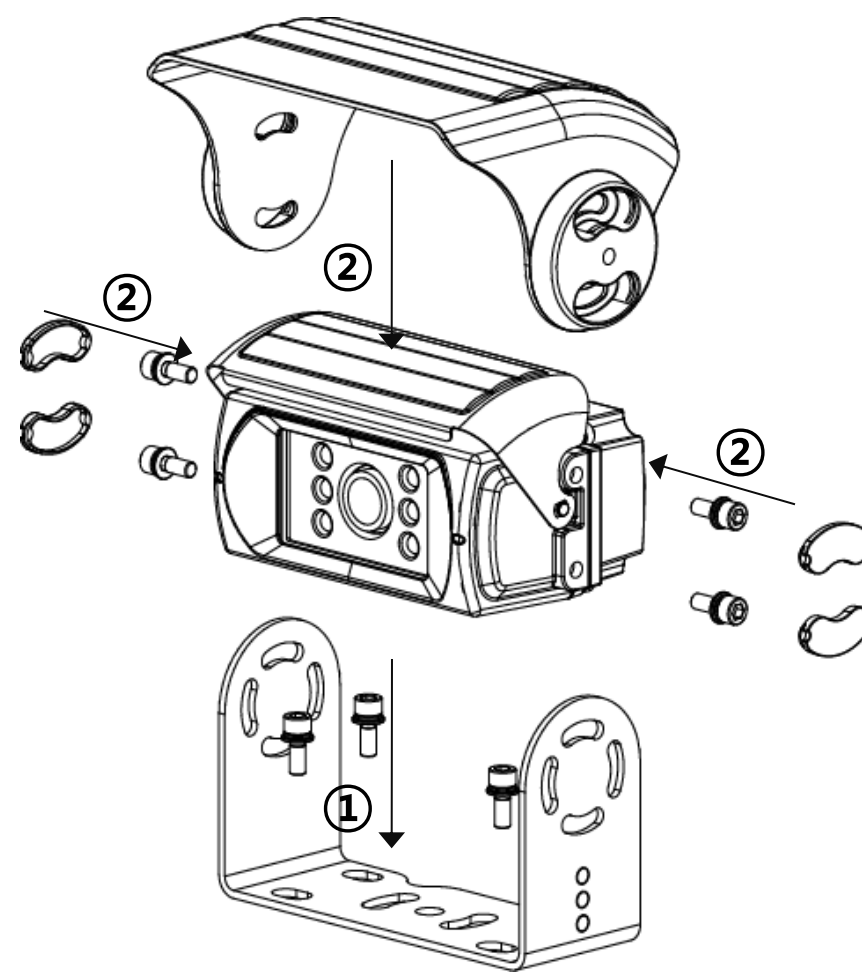

▪ Wiring to Monitor

Run the cable from the camera to the monitor.

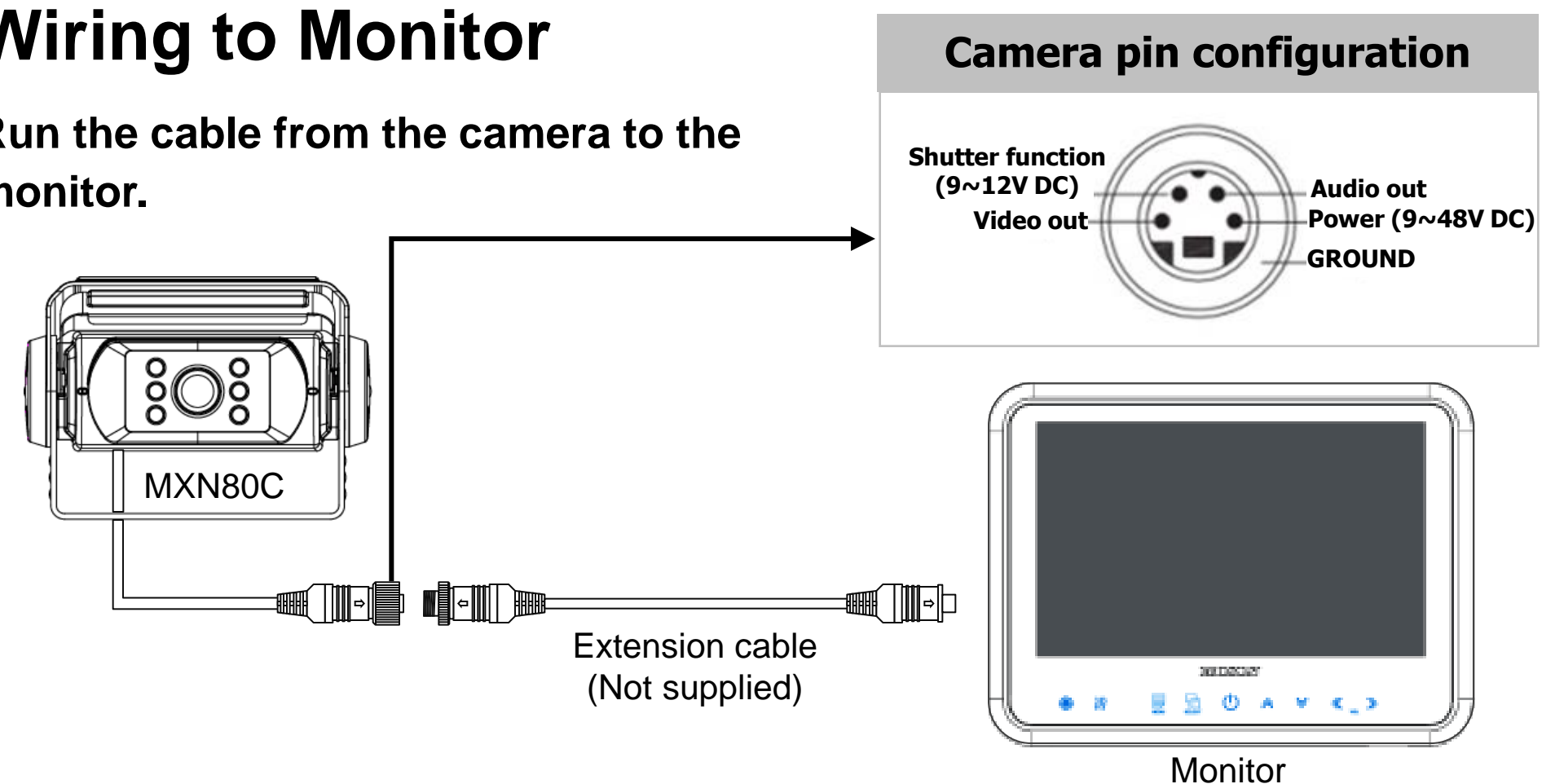

▪ Securing cable connection

1. Match the arrow marks and press the connectors together.
2. Screw the camera connector up clockwise.
3. Tighten cable connection firmly in order to prevent water ingress.



Note!
The warranty will not be valid if the problem is related to moist / corrosion in the connector.

▪ Caution !!

1. Before making the connection, disconnect the ground terminal from the battery to avoid short circuits.
2. The plugs should be fully inserted into the connectors or jacks. A loose connection may cause malfunctioning of the unit.
3. A damaged cable may affect the operation of the camera and may even cause a malfunction of the camera or monitor: Avoid a damaged cable!
4. Protect the cable by using a guide tube, pipe or run the cable inside the vehicle as much as possible. Caution! Run the cable in natural shapes in order to prevent cable breaks.
5. Preferably use an acid free grease in between the waterproof screw type connectors and tighten them firmly each other.